

Welcome to the

Potomac

An open and accommodating main level with the kitchen at its heart is a popular feature of the Potomac Townhome floorplan. Ample light and views are exhibited in the Great Room and open living spaces. As with all of our Townhome floorplans, the Home Owner's Association is responsible for managing exterior maintenance. We would be pleased to discuss new home opportunities with you.

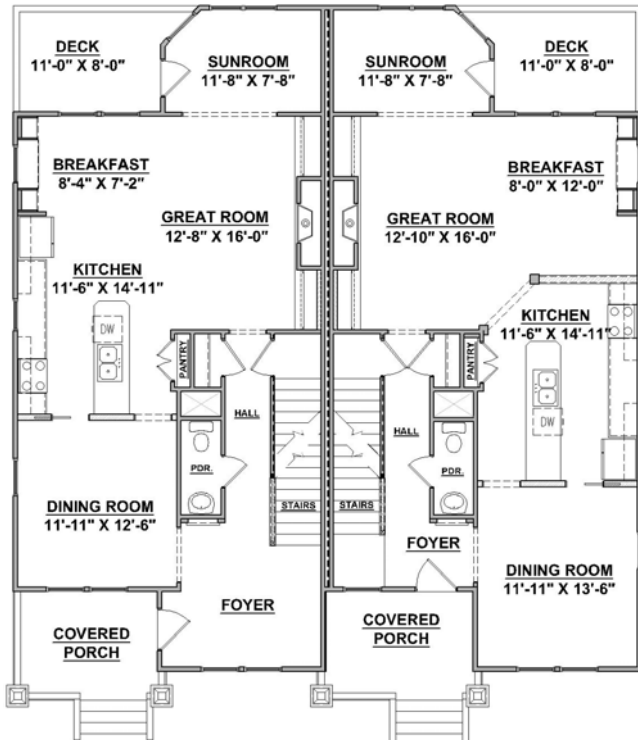

Main Level Floor Plan
1011 square feet

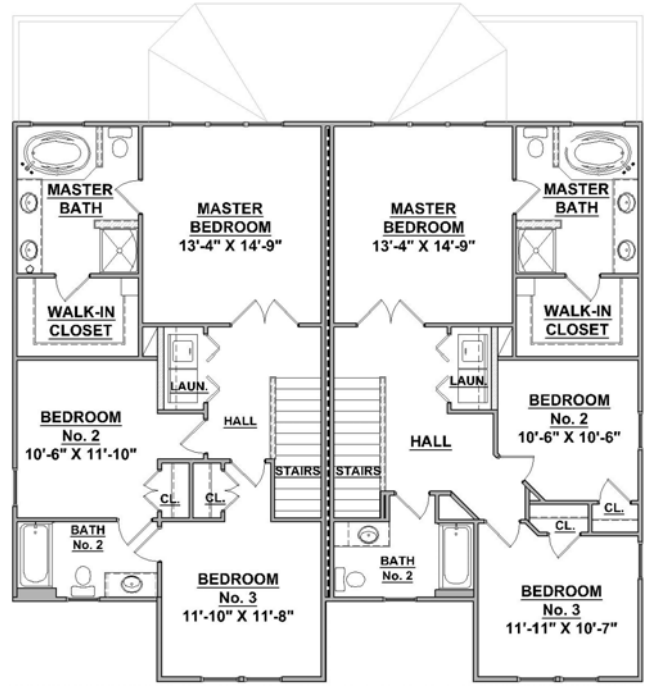

Upper Level Floor Plan
917 square feet



Progress Street
BUILDERS

